



**Rectangular Waveguide Matching Load Data Sheet:**

<b>Connector Type(Waveguide)</b>	<b>Frequency Range(GHz)</b>	<b>VSWR Max</b>	<b>Flange Model</b>	<b>Load Length(mm)</b>
WR430	1.72-2.61	<1.04	FDP/FDM	300
WR229	3.22-4.90	<1.04	FDP/FDM	240
WR187	3.94-5.99	<1.04	FDP/FDM	200
WR159	4.64-7.05	<1.04	FDP/FDM	180
WR137	5.38-8.17	<1.04	FDP/FDM	160
WR112	6.57-9.99	<1.04	FDP/FDM	120
WR90	8.20-12.4	<1.04	FDP/FDM	120
WR75	9.84-15.0	<1.04	FDP/FDM	100
WR62	11.9-18.0	<1.04	FDP/FDM	85
WR51	14.5-22.0	<1.04	FDP/FDM	75
WR42	17.6-26.7	<1.04	FDP/FDM	65
WR34	21.7-33.0	<1.04	FDP/FDM	60
WR28	26.5-40.0	<1.04	FDP/FDM	55

**Note: High-power matching loads can be designed according to user requirements**



Chengdu Sanlianweixun Technology Co., Ltd.

### WR28 Waveguide load

【Product introduction】 :

Features: Great VSWR.

【Technical indicators】 :

1. Working frequency: 26.5~40.0GHz
2. VSWR: 1.05:1 MAX
3. Interface: WR28
4. Structure:

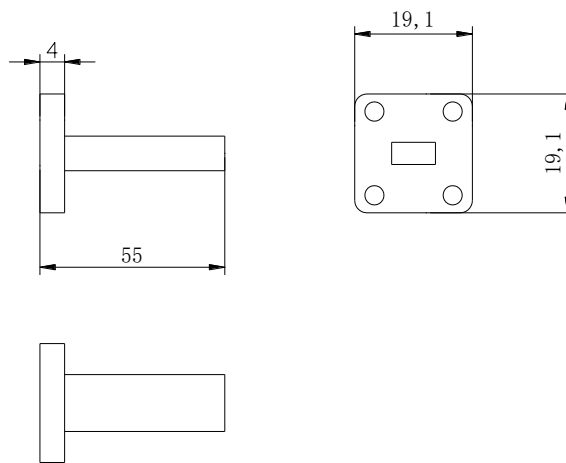

WR28 Waveguide load



**Circular Waveguide Load Data Sheet:**

<b>Connector Type(Waveguide) IEC</b>	<b>Frequency Range(GHz)</b>	<b>VSWR Max</b>	<b>Flange Model</b>	<b>Load Length(mm)</b>
C89	8.49-11.6	<1.04	Customizable	150
C104	9.97-13.7	<1.04	Customizable	130
C120	11.6-15.9	<1.04	Customizable	110
C140	13.4-18.4	<1.04	Customizable	100
C165	15.9-21.8	<1.04	Customizable	80
C190	18.2-24.9	<1.04	Customizable	70
C220	21.2-29.1	<1.04	Customizable	60
C255	24.3-33.2	<1.04	Customizable	60
C290	28.3-38.8	<1.04	Customizable	50
C330	31.8-43.0	<1.04	Customizable	50

**Note: High-power matching loads can be designed according to user requirements**



Chengdu Sanlianweixun Technology Co., Ltd.

## Circular Waveguide Load

【Product introduction】 :

Features: Great VSWR.

【Technical indicators】 :

1. Working frequency: 18.0~32.0GHz
2. VSWR: 1.05:1 MAX
3. Input port type: circular waveguide  $\Phi$  11.6
4. Structure:

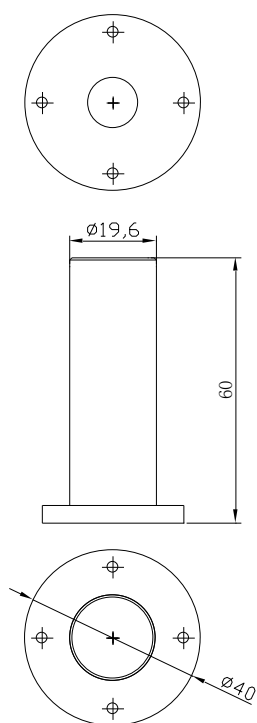

Circular WaveguideLoad