



Chengdu Sanlianweixun Technology Co., Ltd.

Ku band same frequency inphase OMT(type B-D)

【Product introduction】 :

Features: low insertion loss, great isolation and phase coherence.

【Technical indicators】 :

1. Working frequency: 14.0~14.5GHz
2. VSWR: 1.15:1 MAX
3. Insertion loss: 0.15dB MAX
4. Isolation: 35dB MIN
5. phase coherence: $\pm 3^\circ$ MAX
6. Interface: circular waveguide $\Phi 15.09$ (Common port); Waveguide WR75/WR62
7. Structure:

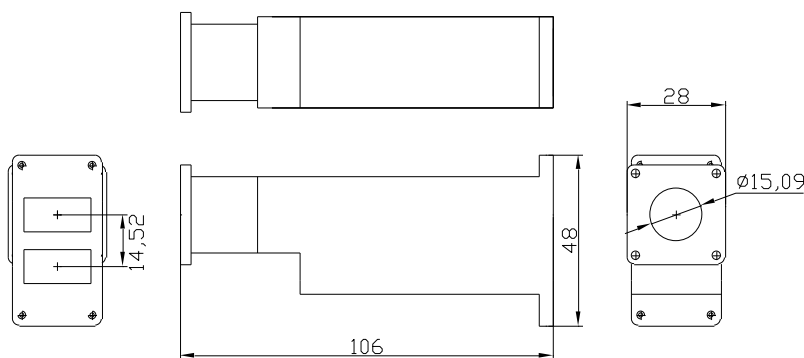

Ku Band same frequency inphase OMT(type B)



Ku Band same frequency inphase OMT(type B)



Chengdu Sanlianweixun Technology Co., Ltd.

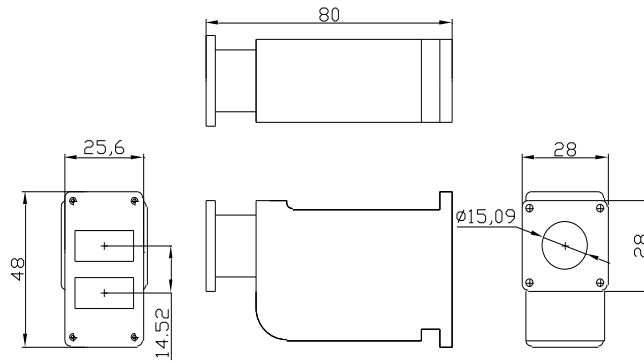

Ku Band same frequency inphase OMT(type C)



Ku Band same frequency inphase OMT(type C)

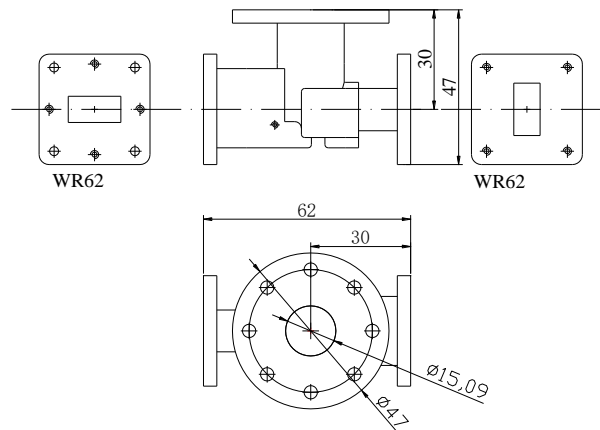

Ku Band same frequency inphase OMT(type D)



Ku Band same frequency inphase OMT(type D)